

Unlocks the ability to control device connected to the 'Control' connection input for a specified amount of time.

## TYPE FEATURES

Control: Relay Input	Access: Relay Output	Message Time	Verify Time	Verification	Show Length	Lockout
Required	N/A	Required	Required	Required	Required	Optional

## EXPERIENCE

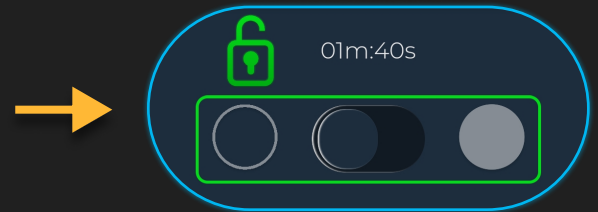
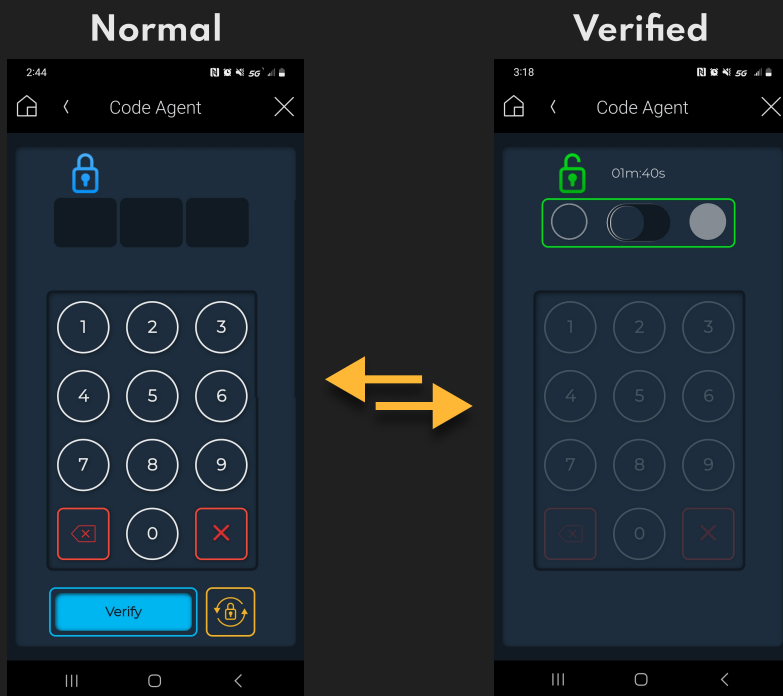

Once the code is verified a control widget will appear that will provide the ability to trigger the following relay commands:

- Open
- Toggle
- Close

These are also available as events in programming to allow for further customization.

### Notes

- Make sure to allow for enough time to control the relay connection
- If **Control** relay connection is not made when using the code type, the driver will enter an **OFFLINE** state
- Though the driver can be bound to any relay binding there may be limitations